

# CALIBRATED RIGGING CHAIN

## CALIBRATED CHAIN(GRADE 80) STANDARD EN818-2

According to the user needs to provide hot-dip zinc, dacromet, metal coated, black, oil and various, surface treatments on the chain.

Safety Assurance: 4-fold safety factor of 2.5 times the proof load.

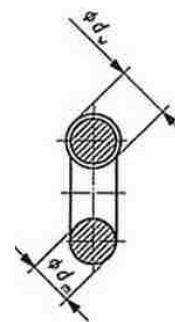
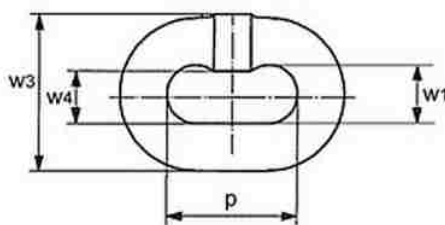

Size dxp (mm)	Width		Approx Weight (kg/m)	Working Load Limit (t)	Test Load (KN)	Breaking Load min.KN
	Inside min.w1	Outside max.w3				
4x12	5.2	14.8	0.35	0.5	12.6	20.1
5x15	6.5	18.5	0.5	0.8	19.6	31.4
6x18	7.8	22.2	0.8	1.12	28.3	45.2
7x21	9.1	25.9	1.1	1.5	38.5	61.6
8x24	10.4	29.6	1.4	2	50.3	80.4
10x30	13	37	2.2	3.15	78.5	126
13x39	16.9	48.1	3.8	5.3	133	212
16x48	20.8	59.2	5.7	8	201	322
18x54	23.4	66.6	7.3	10	254	407
19x57	24.7	70.3	8.1	11.2	284	454
20x60	26	74	9	12.5	314	503
22x66	28.6	81.4	10.9	15	380	608
23x69	29.9	85.1	12	16	415	665
25x75	32.5	92.5	14.1	20	491	785
26x78	33.8	96.2	15.2	21.2	531	849
28x84	36.4	104	17.6	25	616	985
32x96	41.6	118	23	31.5	804	1290
36x108	46.8	133	29	40	1020	1630
40x120	52	148	36	50	1260	2010
45x135	58.5	167	45.5	63	1590	2540